



Building Instructions

Step 1

Map Area

Using a level, mark a level line at 34.5" from the ground using the highest part of your slope.



Pro Tip – Mapping out your design on the wall will help ensure everything will fit before installing cabinets.

Step 2

Leveling Legs

Insert adjustable leveling legs into the cups located on the bottom of the cabinets.



Pro Tip – We recommend using a rubber mallet to ensure legs are fully inserted into the cups.

Step 3

Leveling & Square

Using a level & square, adjust leveling feet to ensure cabinets are level and square.



Pro Tip – Using 2 levels is helpful to ensure cabinets are level from side to side as well as back to front. This will also help save time.

Step 4

Fastening Cabinets To Wall

Once cabinets are level, use fasteners to fasten cabinets to the wall through the back 4" nailer located on the top back part of the cabinet.

We recommend using 2 ¾" Tapcons for masonry walls and 3" Deckmate screws for wooden walls. Pre-Drill using a 3/16" drill bit with a countersink.

We also recommend using composite shims behind the cabinets to keep them positioned on uneven walls such as stucco.



Pro Tip – Use a level to ensure cabinets are kept in a straight flush line.

Step 5

Fastening Cabinets Together

Ensure cabinets are level and flush with each other by following the same instructions from Step 3, using quick clamps to temporarily secure the cabinets to each other.

Pre-drill and countersink behind hinges for a seamless look.

Secure cabinets using 1 ¼" stainless steel screws (Provided in Pro-Package).



Pro Tip – Remove doors and drawers for a faster/easier application

Step 6

Plumbing, Gas & Electrical

Plumbing, gas & electrical can be brought through the cabinets using a hole saw & multitool.

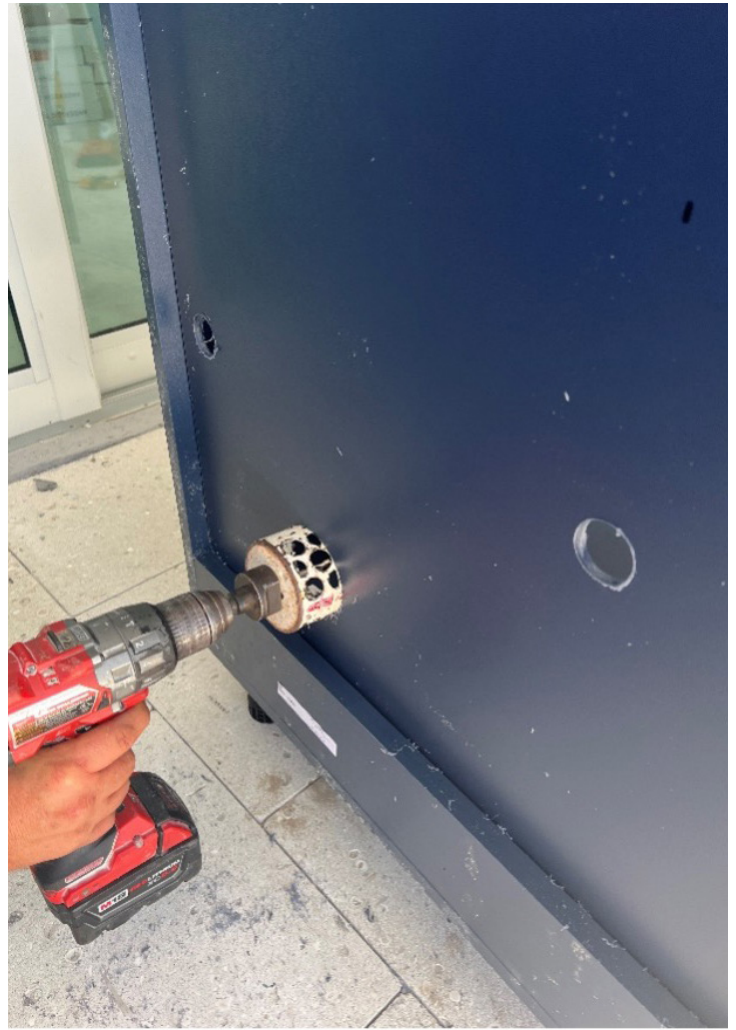

Pro Tip – Always measure from the top of the cabinet for your cut-outs as your floor may be out of level.

Step 7

Fillers & Panels

Fillers & Panels can be cut using a circular saw or table saw, keeping in mind that all cuts will leave you with an unfinished edge. Make sure all unfinished edges are facing away towards a wall or floor for a perfect clean look.

Using clamps, secure the panel to the side or back of the cabinets and fasten using the same method of attaching cabinets together.

Panel size will be determined by measuring from the floor to the top of the cabinet if using full height panels and from the back of the cabinet to the front of the door face for a perfectly flush look.

Pre-Drill using a countersink.

Side Panels- Require 1 ¼" stainless steel screws (Provided in Pro Package).

Back Panels- Require 1 5/8" stainless steel screws (Provided in Pro Package).



Pro Tip – Track saws or using a level as a straight edge are a great way of cutting an angled cut.

Step 8

Toe Kick

Measure and cut toe kick using a circular saw or table saw. Height of the toe kick will be determined by the slope of your floor.

Lay the toe kick on the floor being careful not to scratch it.

Using a marker, mark locations of the center of the legs on the back of the toe kick for the mounting brackets. Attach mounting brackets to the back of the toe kick using a pre-drill and $\frac{3}{4}$ " stainless steel screws.

Mounting brackets and $\frac{3}{4}$ " stainless steel screws will also be provided in your (Pro-Package).

Slide clips into mounting brackets and snap the toe kick to the cabinet legs.

Toe kick is now removable and able to re-attach as needed.

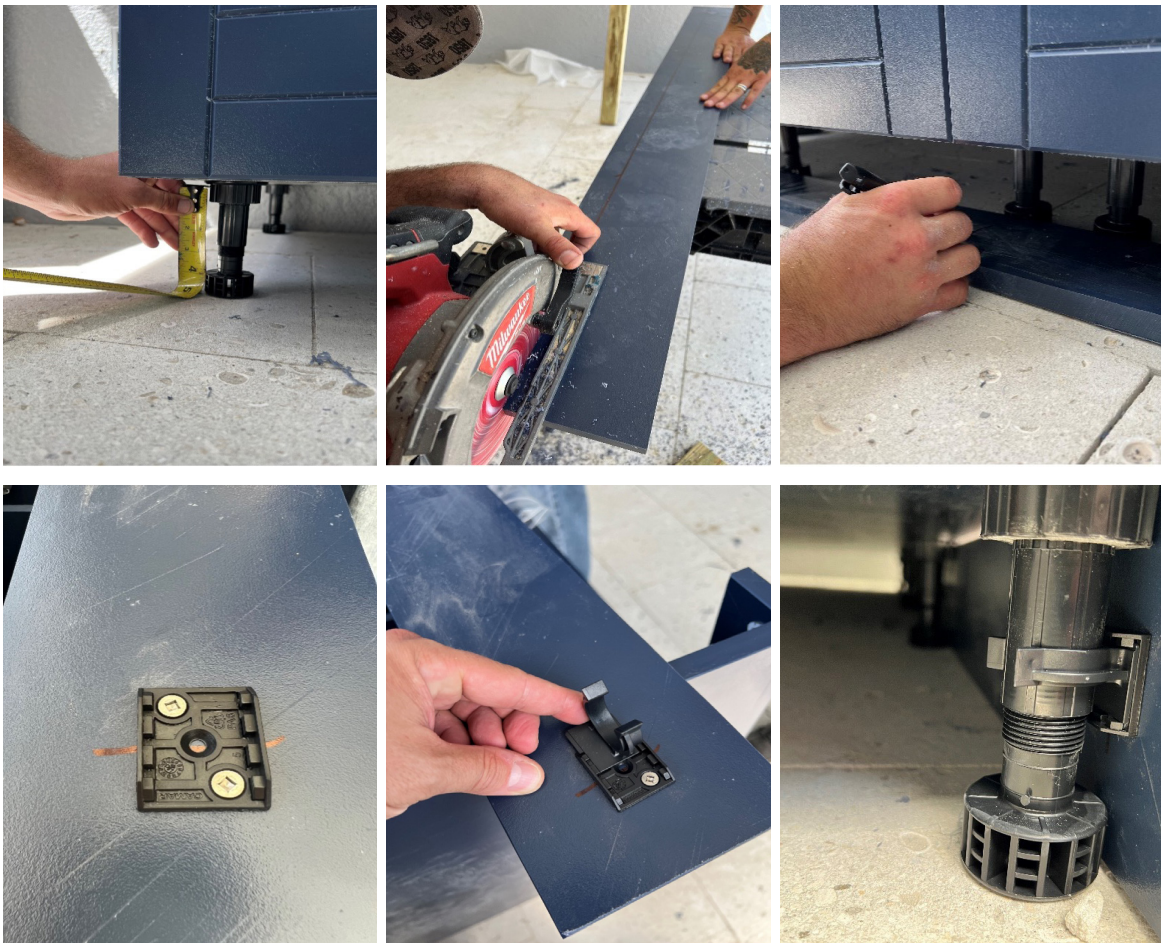

Pro Tip – Track saws or using a level as a straight edge are a great way of cutting an angled cut.

Step 9

U-Frame

The U-Frame is a custom piece made to wrap around your insulation liner.

Using a 3/8" bottom bearing router bit, cut out the center and discard leaving you with a "U-Frame."

Attach U-Frame above grill or appliance base doors using stainless steel L-Brackets and 3/4" stainless steel screws (Provided in your Pro-Package).



Pro Tip - Use shims to space your U-Frame 1/8" above your doors. We use a hot glue gun to temporarily secure the U-Frame in place to keep it from moving when securing.

Step 10

Adjusting Doors

Doors may need to be adjusted after installation. Hinges can be adjusted using a standard Phillips head screwdriver.

There should be approximately 1/8" spacing between doors & drawers.

